

VARIANTE AL PIANO DI RECUPERO

denominato

'CORTILE BREDA'

approvato con delibera del C.C. n°48 del 25/09/2008

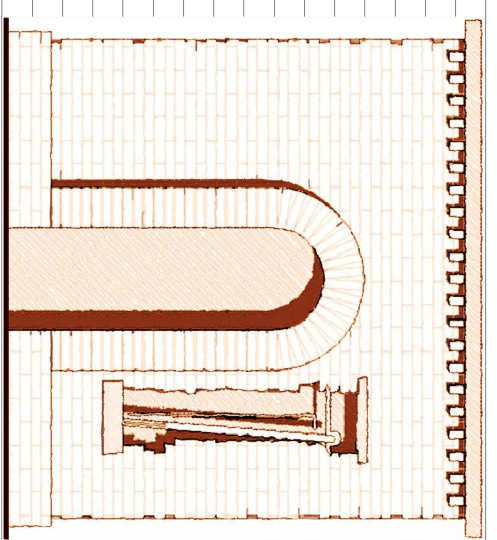

Committente: -società CORTILE BREDA s.r.l.

Progetto: - Arch. Lino Raimondi

- Arch. Pietro De Stefani

- Arch. Monica Moroni

Cologno al Serio, il 04 gennaio 2016



STUDIO L'OTTAGONO
Dell'Architetto Lino Raimondi

Cologno al Serio - Via V. Veneto, 38
Tel. 0331.830000 Fax 0331.830000 e-mail: l.ottagono@gmail.com
esempio: 315.24@studio.breda.progetto.ottagono.com

356

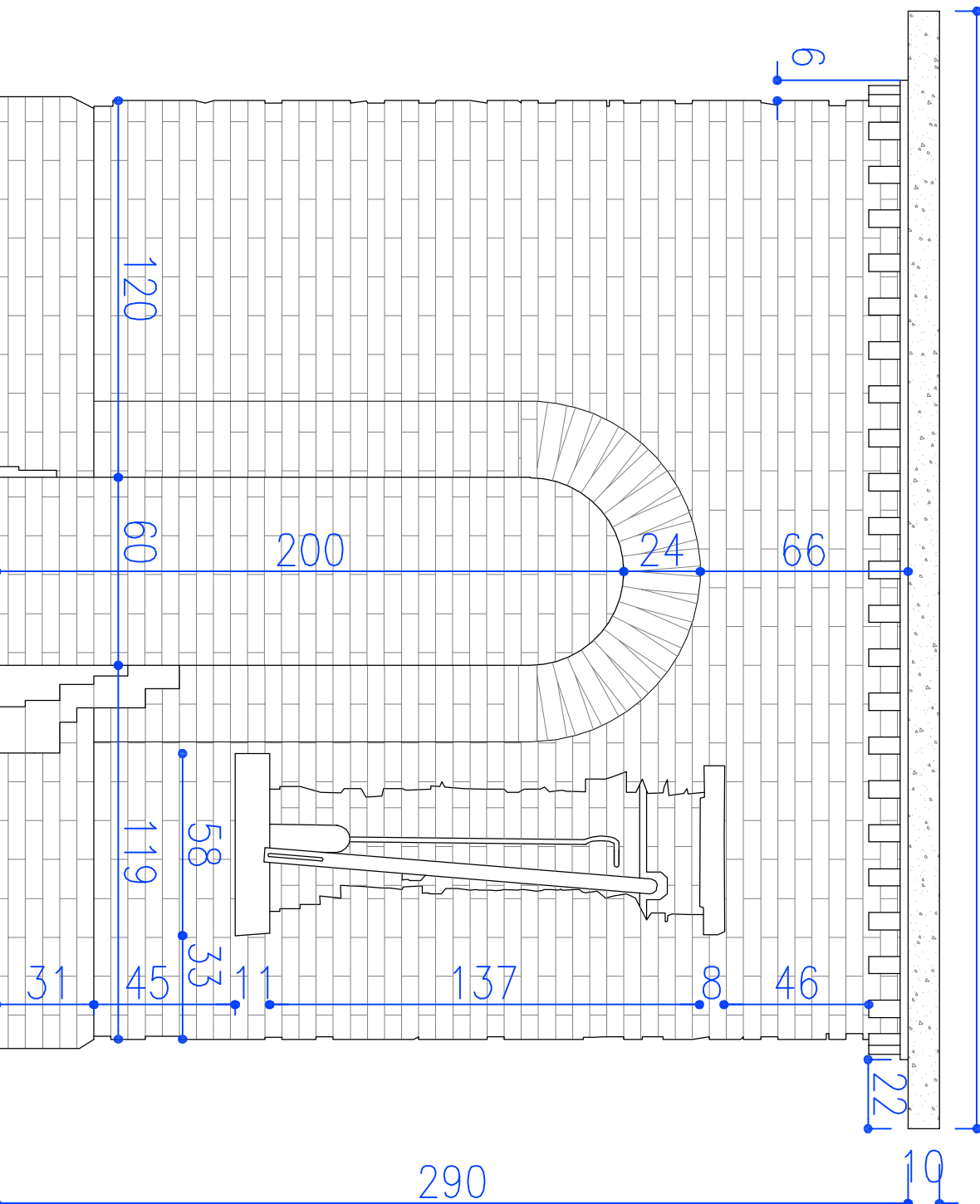

Prospetto frontale

scala 1:20

Sezione

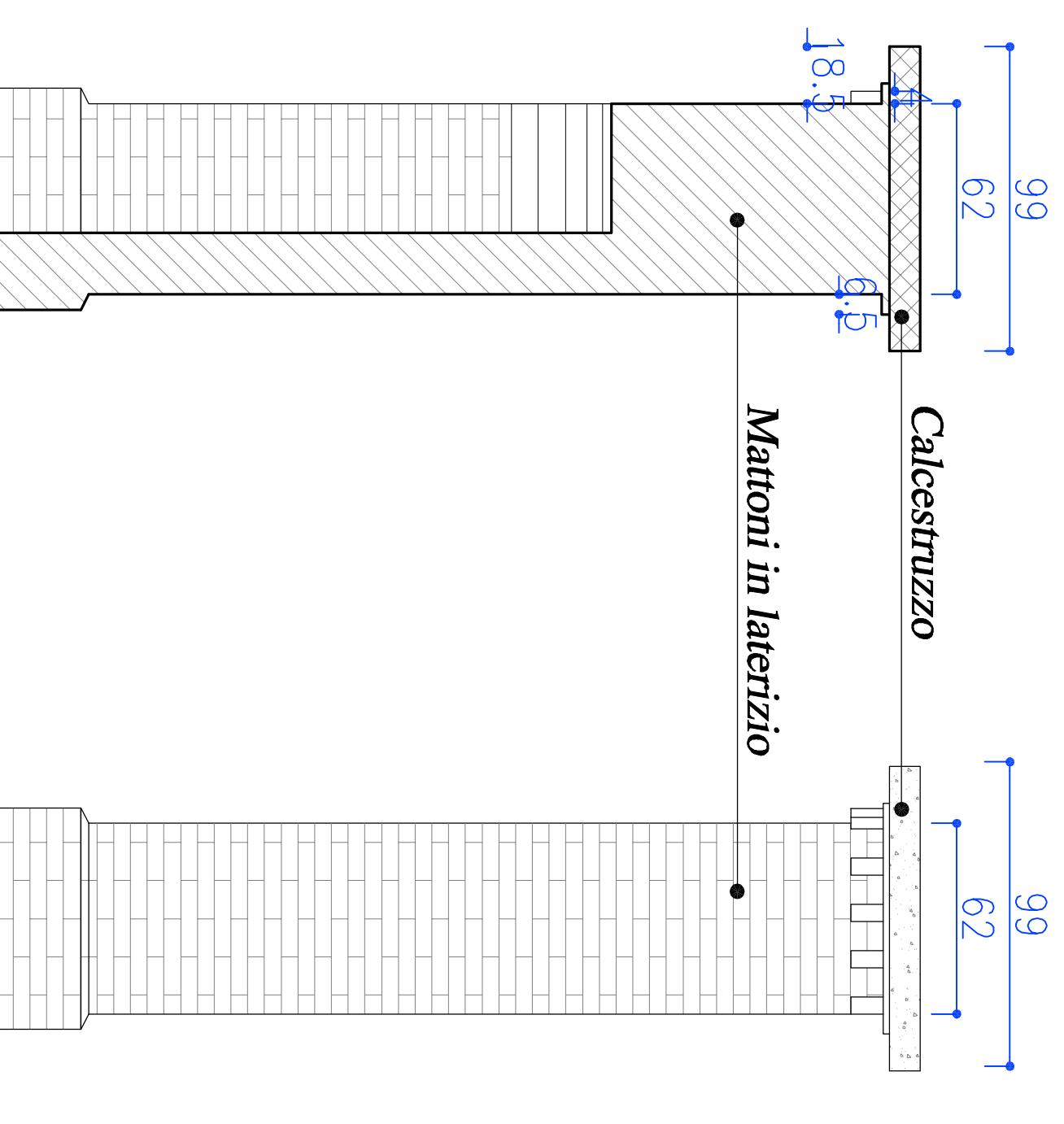

Prospetto lato



Pompa acqua - particolari

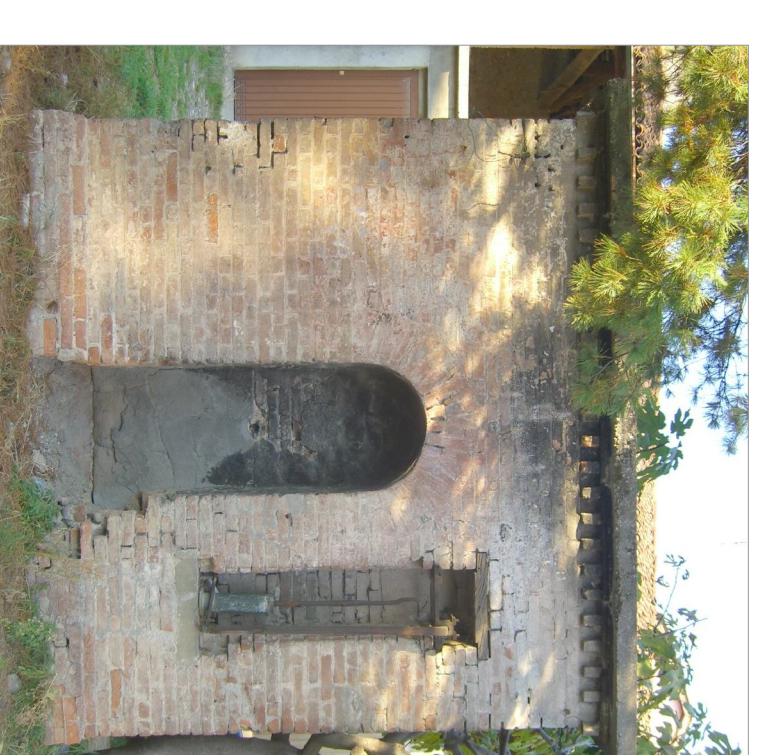

Pompa acqua - fronte

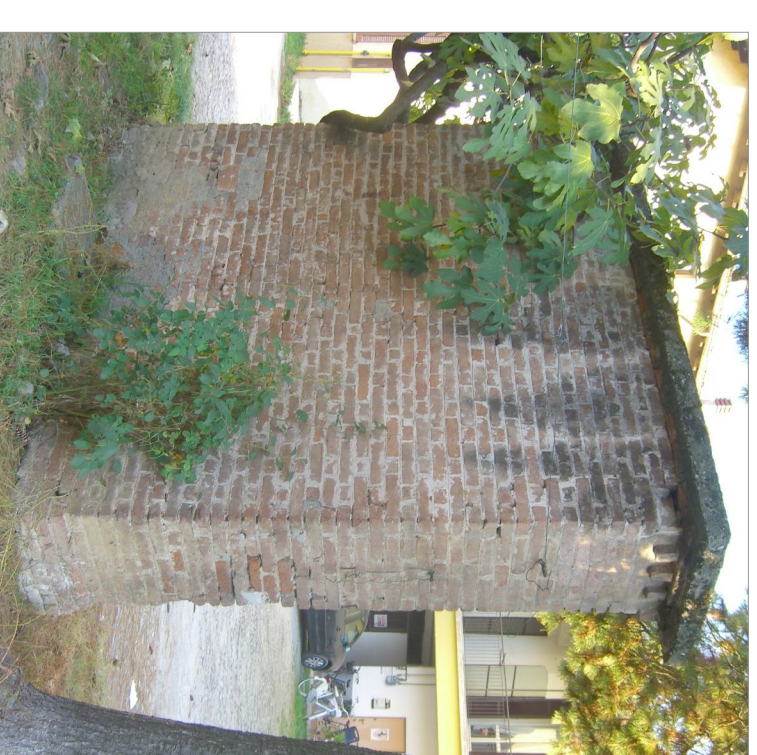

Pompa acqua - retro



Ballatoio verso corte con parapetto in legno



Arco ribassato del vano scala



Serramento e inferrata

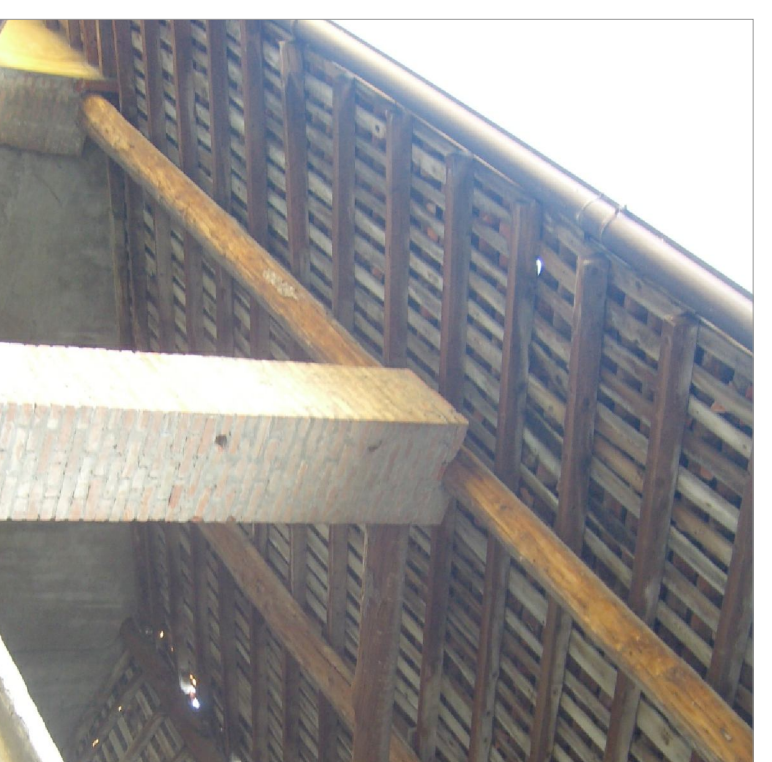

Gronda portico cortile



Gronda portico cortile

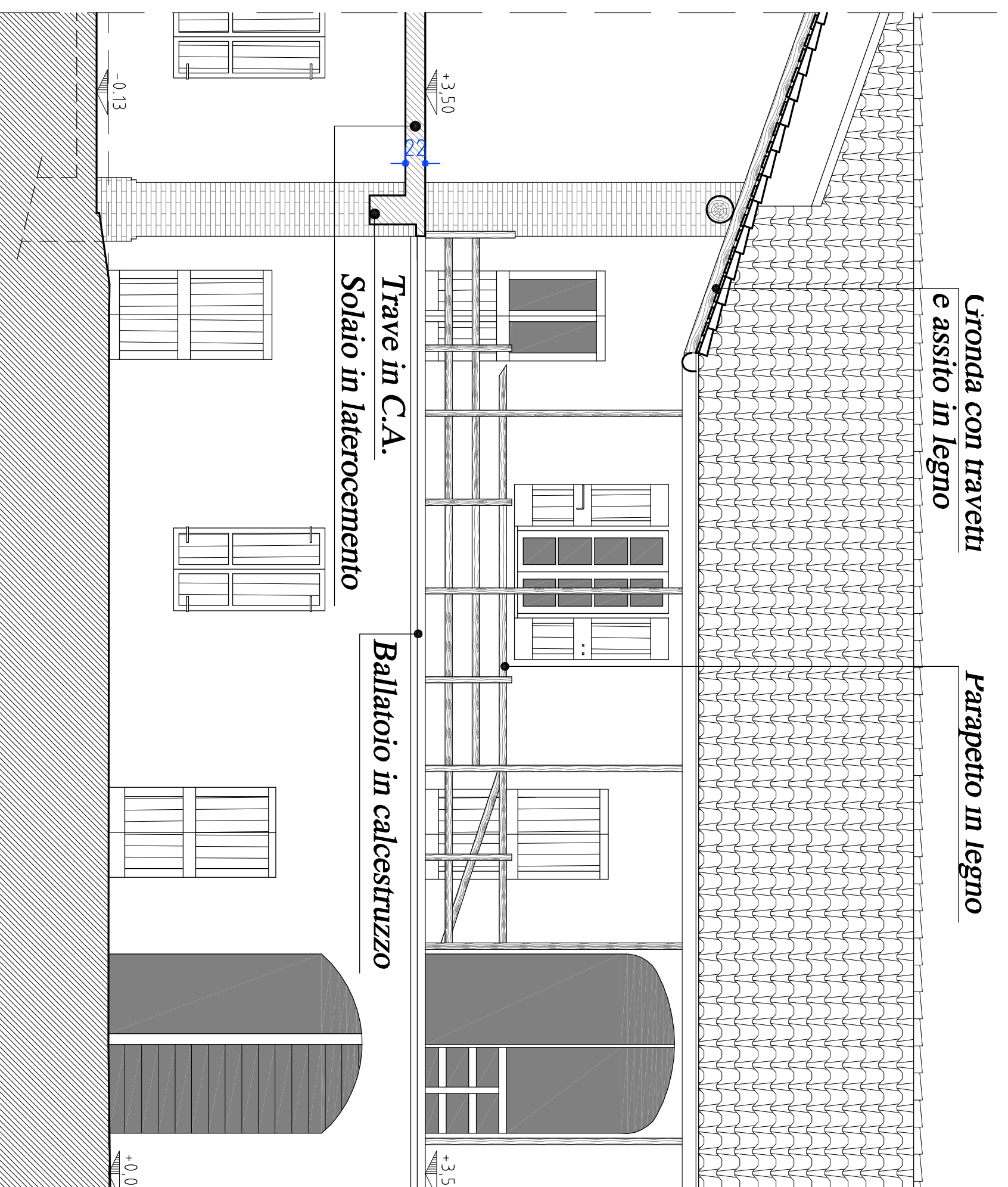

Prospetto cortile interno - lato ovest

scala 1:50



Serramento con ante chiuse



Serramento in legno verniciato

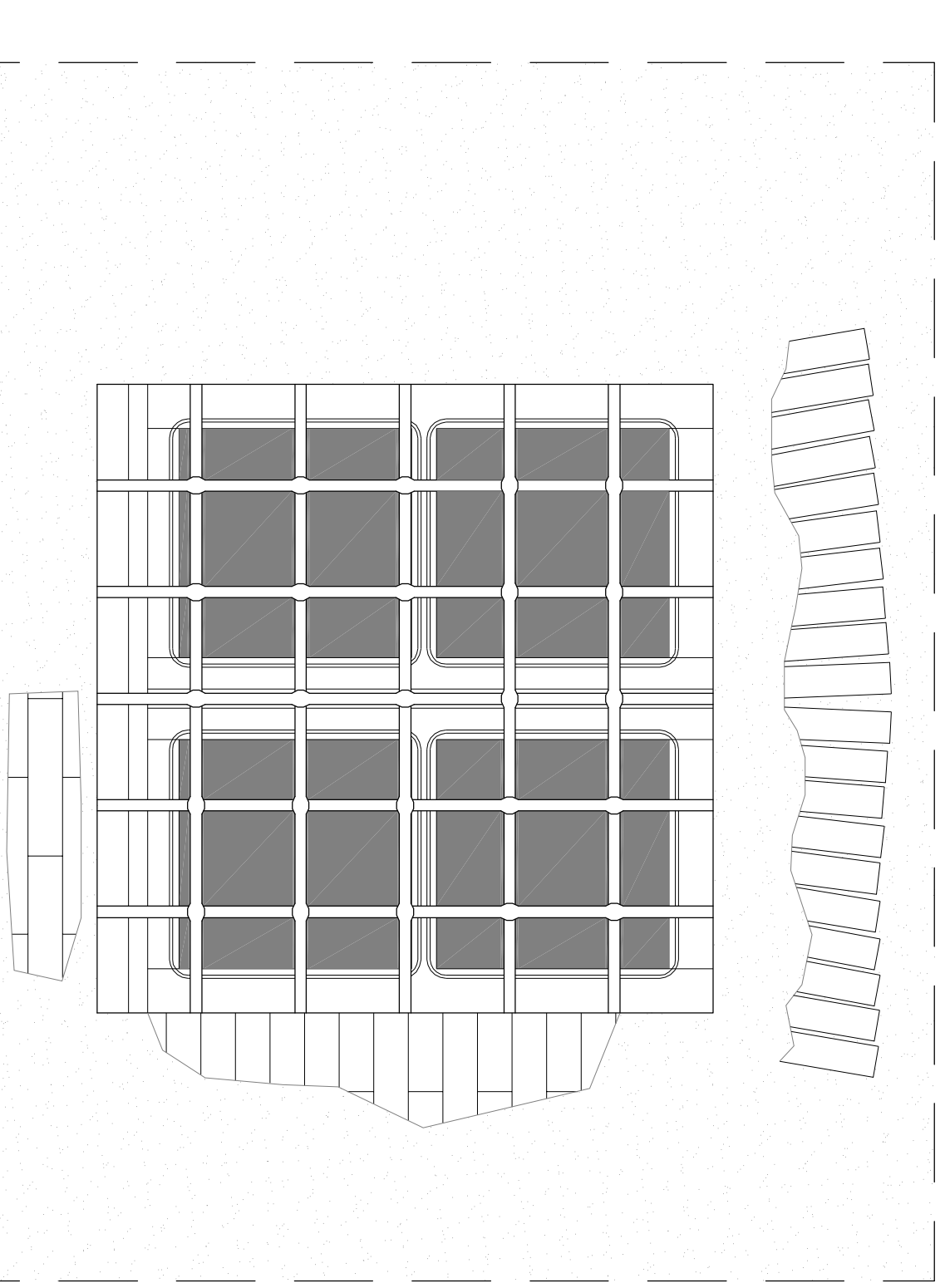

Serramento e inferrata

scala 1:10

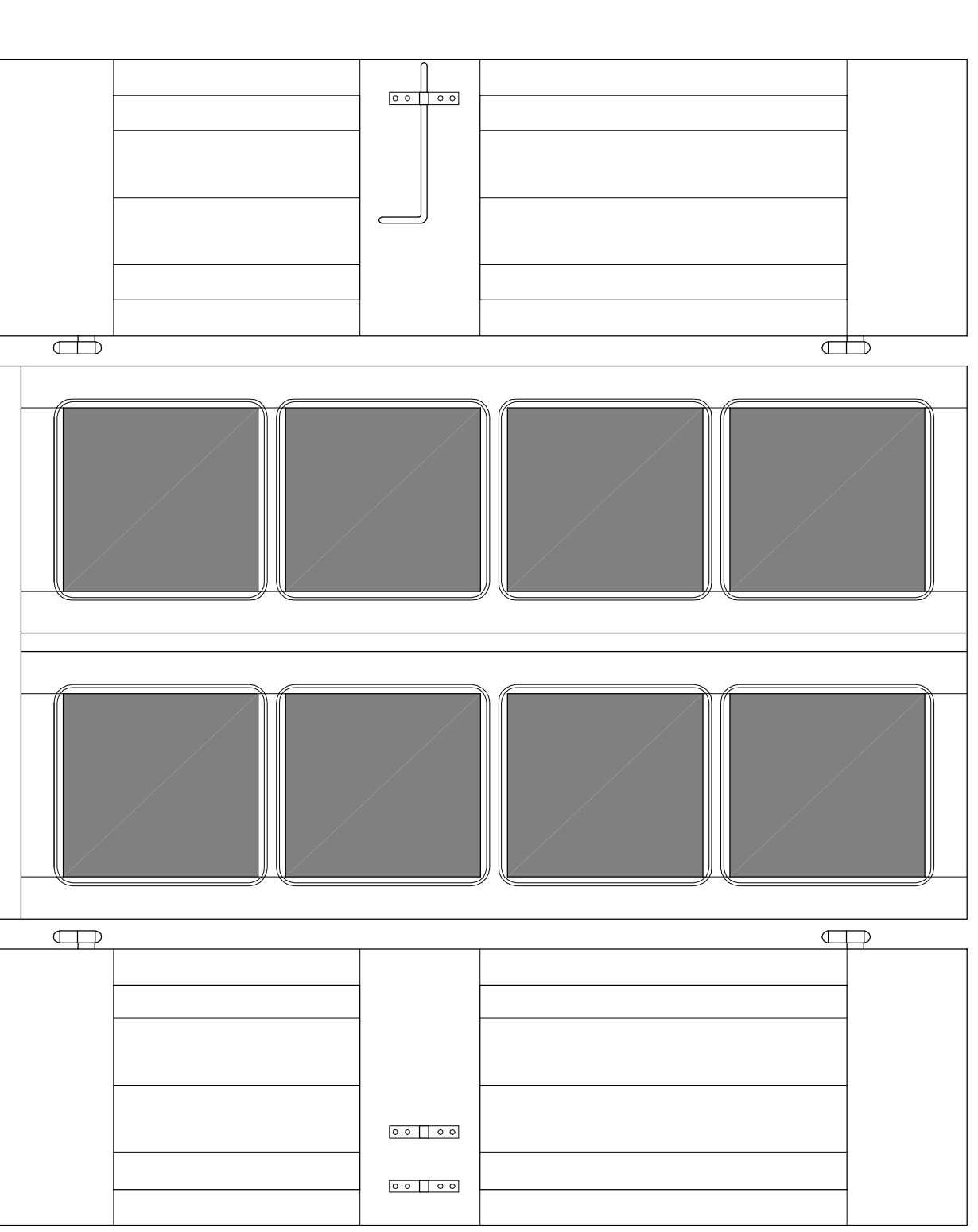

Serramento cortile - lato ovest

scala 1:10